

KIMER

We create space



Since 1963



Lockers



Description

Kimer modular lockers are the perfect equipment for your changing room, thanks to their attractive finish.

The lockers are fully detachable, allowing modules to be added or removed to adapt to the available space at any time.

The multiple combination options and different accessories make them suitable for a wide range of needs (sloping tops, baseboards, feet, side panels...).



Applications

Secure storage of personal belongings or items.

Combines attractive design with a refined finish.

A wide range of useful accessories for various storage needs, as well as finishes that ensure hygiene in humid environments.







Since 1963



KIMER **ADVANTAGES**

- 1
- 2
- 3
- 4
- 5
- 6

1 Easy assembly

Following the Kimer assembly manual, the lockers can be quickly and easily assembled.



2 Optimization

Kimer lockers optimize facilities by sharing side panels between the intermediate modules of a locker unit.



3 Reduction of required stock

All components are compatible with each other. Side panels are compatible with all locker models, and both backs and shelves are compatible with corresponding widths.



4 Option to supply as a kit

All Kimer locker models can be supplied in a single package containing all necessary components along with an assembly manual.



5 Quality

The locker edges are rounded to prevent sharp elements. The backs feature a grille for good ventilation without the need to perforate the door.



6 Anti-theft system

They include an anti-theft locking system (accessory included in the price of the Alexa series lockers), providing enhanced security.





Available models

Front length of the lockers in centimeters.



1-DOOR LOCKER

25	30	40
----	----	----



2-DOORS LOCKER

25	30	40
----	----	----



4-DOORS LOCKER

25	30	40
----	----	----



CHANGING ROOM
BENCH LOCKER

25	30	40
----	----	----

Allows a changing room bench to be placed in front of the locker without needing a corridor for door opening.

All Kimer lockers, regardless of width have a total height of 1800mm and a depth of 504mm.

With feet and sloping top installed, the total height is 2200mm.

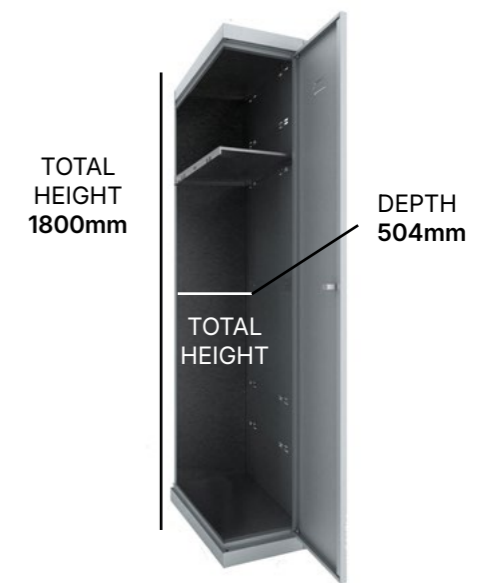
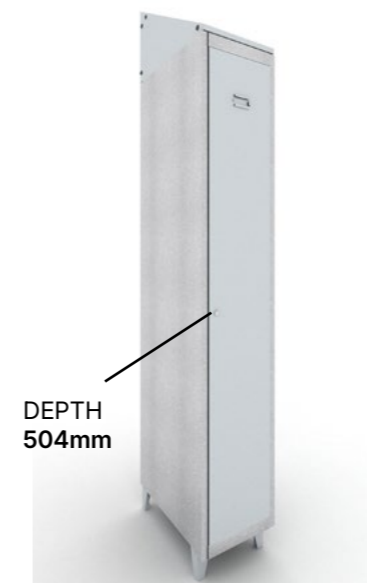



The useful width of the locker equals the front width plus five centimeters.



Finishes





**TEXTURED BIOSAFE PAINT
FINISH RAL-7035**

-  **Galvanized:** locker back and shelves.
-  **Textured Biosafe gray RAL 7035:** frames, locker side panels, and doors.





**FLAME-RETARDANT
PAINT FINISH M1**

-  **Galvanized:** shelves.
-  **Blue RAL 5003:** frames, locker sides, and back.
-  **Gray RAL 7035:** doors.



**TEXTURED BIOSAFE PAINT
FINISH RAL-5023**

-  **Galvanized:** shelves.
-  **Textured Biosafe blue RAL 5023:** frames, sides, and back.
-  **Textured Biosafe gray RAL 7035:** doors.

Biosafe textured paint

TEXTURED FINISH

This paint contains an antimicrobial agent that inhibits and destroys the ability of cells to function, preventing the growth of harmful bacteria on the treated surface. It is based on a non-toxic, environmentally friendly, natural silver component that lasts the entire lifecycle of the powder coating. It fights and eliminates bacteria through a trimodal effect:

- Inhibits respiration at the cell wall
- Inhibits cell reproduction
- Disrupts cell metabolism



Effective against more than 30 bacteria, including Legionella, E.coli, Salmonella, Streptococcus, Listeria, Staphylococcus, etc.

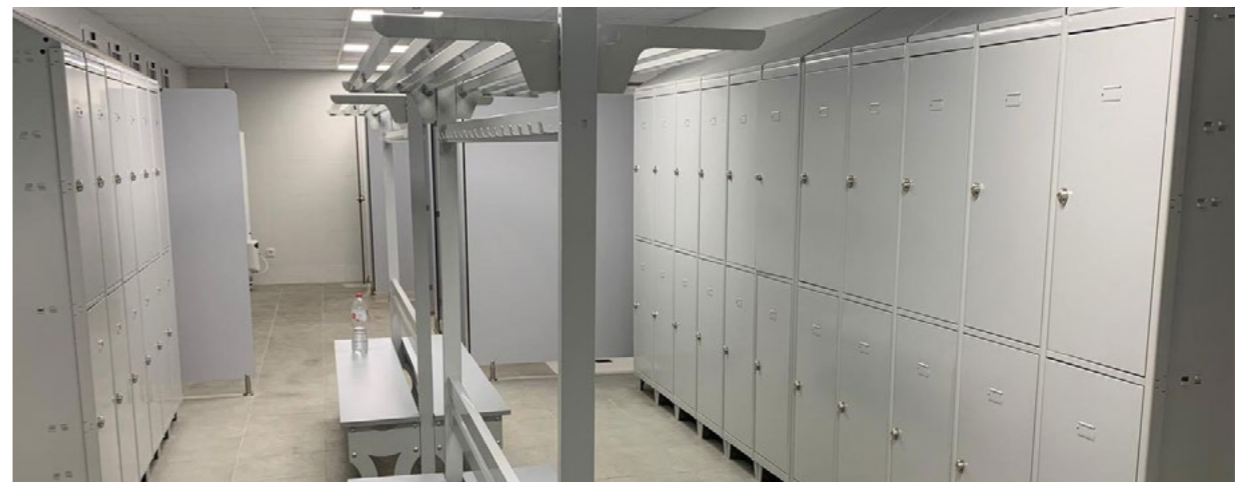



System components

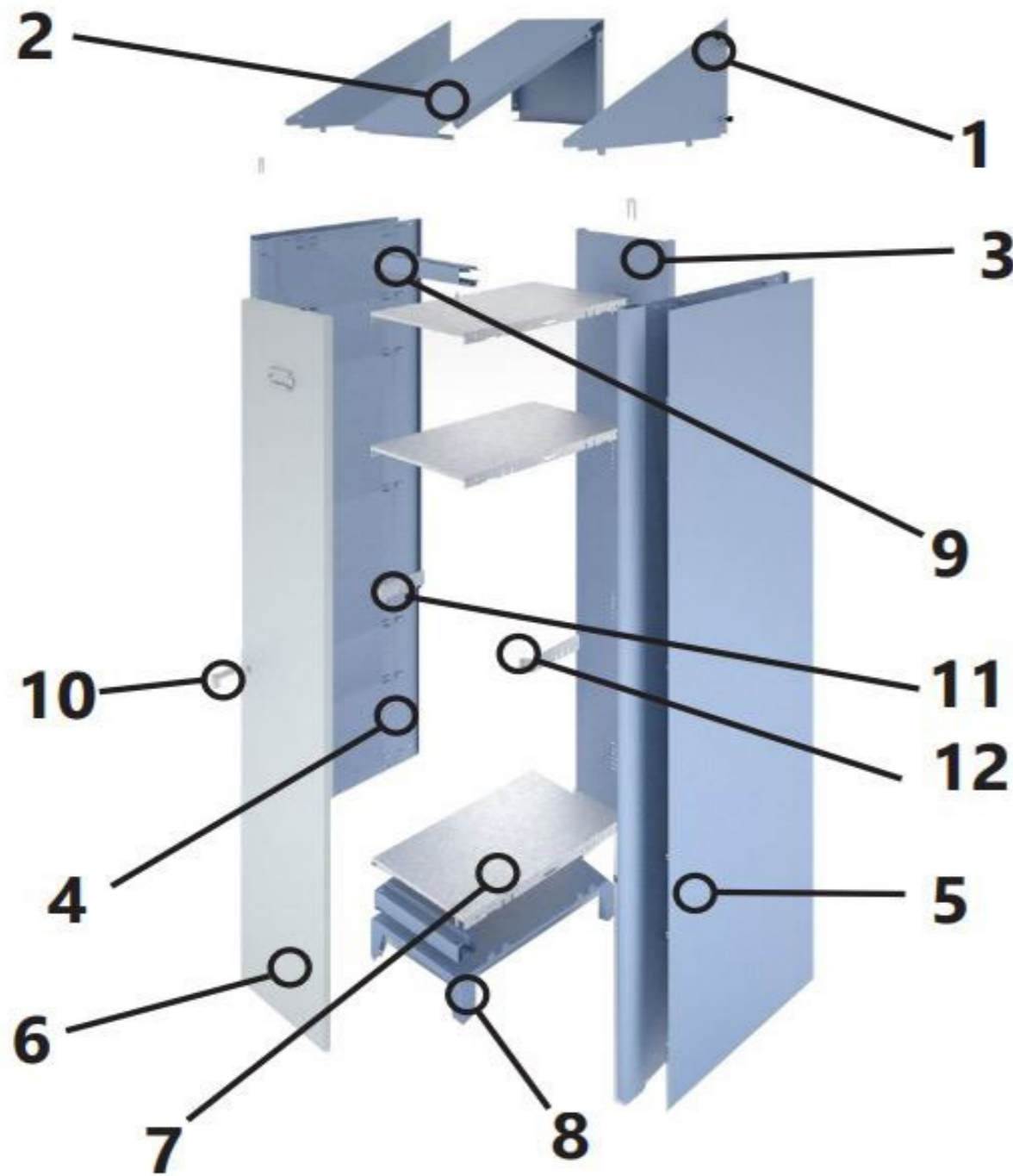

- 1 SIDE TRIANGLE FOR SLOPING ROOF
- 2 SLOPING ROOF
- 3 LOCKER BACK
- 4 LOCKER SIDE
- 5 STETIC SIDE PANEL (LEFT/RIGHT)
- 6 LOCKER DOOR
- 7 LOCKER SHELF
- 8 LOCKER FEET
- 9 INITIAL/END FRAME
- 10 LOCK
- 11 RIGHT STOPPER
- 12 LEFT STOPPER

For fast and simple assembly, refer to our assembly manual locker assembly manual



We create space

Components

Doors

Kimer locker doors ensure the security of the items stored inside. They can be paired with different types of locks.

Available in three different widths to suit all needs.

SIZES	25	30	40
-------	----	----	----



Back panels

Located at the rear of the lockers, they feature slots that allow air circulation within the unit.

SIZES	25	30	40
-------	----	----	----



Side panels

Together with the back panel, they form the external structure of the locker. They include slots that allow shelves to be positioned at various heights.

Locker frame

A support element that braces the locker side panels together. Available in RAL blue or Biosafe finish (blue or grey).

SIZES	25	30	40
-------	----	----	----



Shelves

Easily inserted into the slots on the side panels without screws.

SIZES	25	30	40
-------	----	----	----



Clothe rail

Designed to hang all types of garments.

SIZES	25	30	40
-------	----	----	----



Towel ring

Included as standard in some locker models. Allows towels to be hung inside the door.

Not available in the Alexa locker.



Towel ring





Accessories

Locker accessories are available in:

- Textured grey RAL 7035
- Textured blue RAL 5023
- Smooth blue 5003

Vertical divider

The main function of this accessory is to divide the locker interior, creating two separate spaces.



Locker foot

Raise the locker off the ground for easier cleaning and protect it from rust.

SIZES	25	30	40
-------	----	----	----

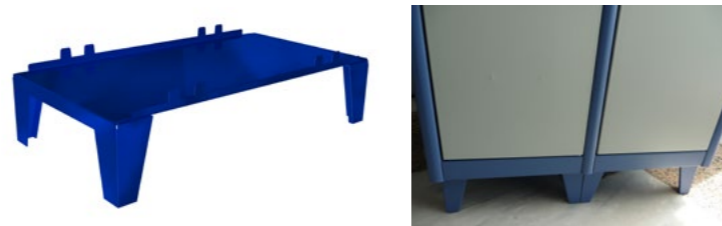

Stainless steel feet

Provide extra protection against rust.

SIZES	25	30	40
-------	----	----	----

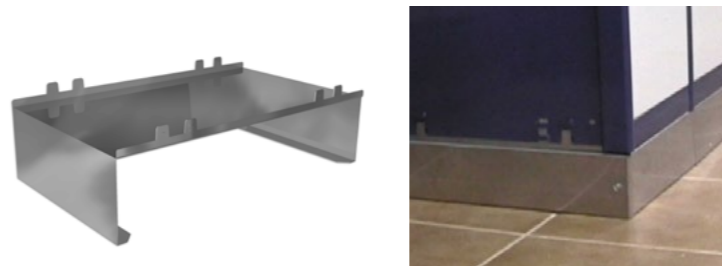

Sloping top

Prevents dust from accumulating on top of the locker.

SIZES	25	30	40
-------	----	----	----



Antitheft-system

By embedding the lock into this accessory, it prevents the door from being forced open with a lever.

Installed in the inner sides of the locker, at lock height. These pieces also serve as stoppers when the door is closed, giving it greater resistance and rigidity.

Included as standard in the Alexa model and adaptable to other locker models as an option.

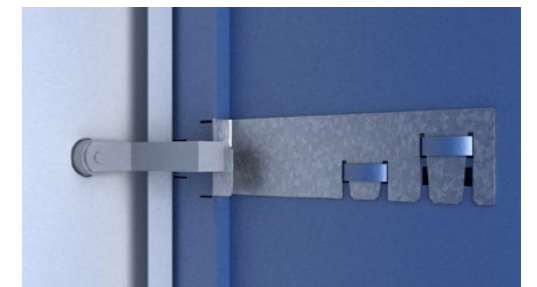

Stetic side panel

Can be placed on the first and last side of a row of lockers. **Covers the perforations in the side panels for an exceptional aesthetic finish.**

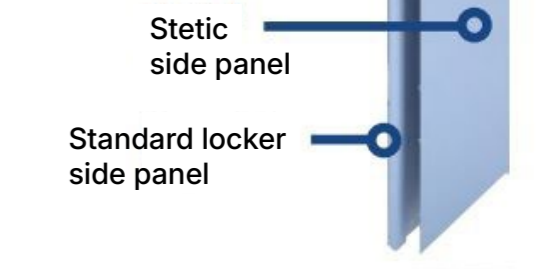

Look options



Standard lock



Padlock Lock



Coinn-operated logo

Antitheft system

Stetic changing room benches

The Kimer changing room bench is the perfect complement to the lockers.

SIZES	500	1000	1500	2000
-------	-----	------	------	------

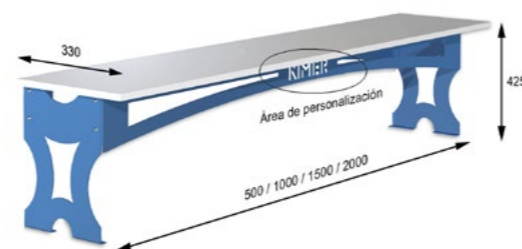

Tubular changing room benches

Available in 1750 mm size and smooth gloss blue RAL 5003 finish.



Changing room benches with elevated rack

Kimer's most complete solution. Combines the functionality of a bench with extra storage space and added comfort by incorporating a backrest.

SIZES	1000	1500	2000
-------	------	------	------

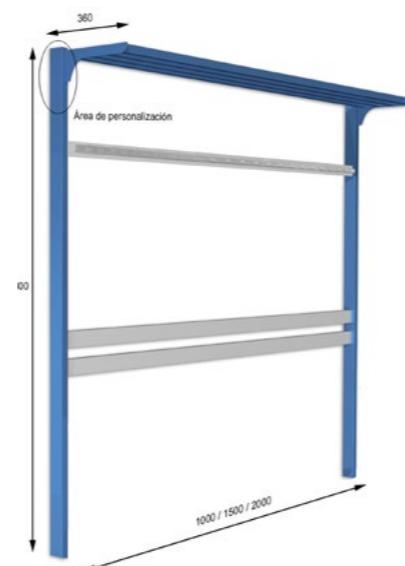

The best quality at the best price

The Alexa locker includes left and right stoppers for easy assembly, increasing locker strength and improving security by allowing the lock to be effectively secured.

Side panels and doors are finished in textured Biosafe paint RAL-7035. Locker backs and shelves are finished in pre-galvanized steel.

Two models available: Single unit and Double unit.

SIZES	25	30	40
-------	----	----	----

THE BRAND

At Kimer, we have been designing and manufacturing storage systems for over 60 years.

We work every day to help you make the most of your space. We manufacture all types of storage racking systems, applying the same dedication and enthusiasm to every project, regardless of its size.

Everyone at Kimer is confident in our ability to help you find everything you need for your new warehouse installation.

If you want to learn more about our company or our products, these QR codes will take you to our website and our corporate video, respectively.



WEBSITE QR



VIDEO QR

HISTORY



When Kimer opened its first factory in Quart de Poblet in 1963, it contacted local artist **Nassio Bayarri** to create a piece that would reflect the company's image and aspirations.

As a result, Nassio created the artwork that now crowns our façade, made from our very first product: the slotted angle profile. The piece represents the Moon landing, and was completed in 1968. Apollo 11 landed on the Moon in 1969—one year after Kimer installed this sculpture. From that moment until today, Kimer has remained at the forefront of technology and development.

Looking to the future, **Kimer** continues to focus on growth based on quality, environmental awareness, and technological innovation.

R&D DEPARTMENT

At **Kimer**, we have an R&D department that designs all our products using the most advanced structural analysis software.

We study stress, deformation, and tension distribution to ensure our installations are **100% safe** while offering **the most competitive prices**.

To validate our calculations, the main components of our products are tested for breakage, deflection, and fatigue, both internally and by independent laboratories.



KIMER QUALITY



EN 1090 Certification

Kimer is certified to issue CE marking for self-supporting structures. This standard includes regular testing of welding penetration on both robotic and manual welds.

ISO 9001 Certification

Ensures ongoing quality controls and the traceability and registration of our products.



All our products are 100% manufactured by Kimer.

We use only certified premium-grade steel.

We guarantee full traceability of all components.

100% Spanish manufacturing.

We apply the most rigorous design standards on the market.

Our key components are regularly tested by independent, highly regarded laboratories.

We do not use harmful components in our painting processes.

We recycle all process water using reverse osmosis.

We treat contaminated elements via pyrolysis for later recycling.

ENVIRONMENT

FAMILY-OWNED COMPANY

At Kimer, we are deeply aware of the current environmental crisis and strive to be part of the solution.

That's why we are committed to the following actions:

- ▶ A 714 kWp solar self-consumption installation, preventing the emission of 400 tons of CO₂ per year.
- Eliminating all harmful components from our painting processes.
- Recycling all water used in our production through reverse osmosis.
- Pyrolysis treatment of contaminated elements for responsible recycling.
- Minimizing natural resource use and the generation of hazardous waste.

**KIMER HOLDS
ISO 14001
ENVIRONMENTAL
CERTIFICATION**



At Kimer, we take great pride in being a **family business**. For over 60 years, we have evolved and adapted to changes in the market, always maintaining strong values and a family-oriented culture. This allows us to offer **close, personalized** service and find the right solution for every client.

We are truly proud to be what we are: a family company.

INTERNATIONALIZATION

TECHNOLOGY



Today, Kimer exports **80% of its production to over 45 countries.**

Our experienced commercial and logistics team allows us to meet both national and international demands in a constantly evolving industry.

Currently, Kimer operates two production plants totaling over 25,000 square meters, with a production capacity of 55,000 tons per year.

At Kimer, we use the latest technologies in the manufacturing of steel profiles. Our state-of-the-art CNC roll forming machines deliver clean cuts and precise punching.

We apply robotic welding controlled by artificial vision systems to ensure clean, uniform welds with virtually no spatter. We also have in-house laser cutting technology (for both tubes and sheets), allowing us to develop custom accessories to meet all our clients' needs.

With automated painting booths, we apply epoxy coatings that give our products high chemical resistance to corrosive substances, along with a high-quality aesthetic finish.

KIMER Products



Picking

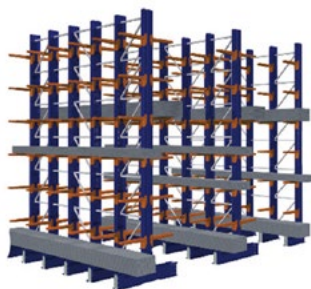

Cantilever



Compact Pallet Racking



Mezzanine



Pallet racking



Easy Rack



Slotted angle

We create space

Avda. Santa María de Poblet, 26
46930 Quart de Poblet (Valencia)

+34 961 536 134

kimer.com
comercial@kimer.com

KIMER

We create space



Since 1963

Website



Corporate video



Official dealer